

Bountiful!

HARVEST TIMES



ISSUE 1 | THURSDAY, JUNE 25, 2015 | 36TH BIENNIAL LWML CONVENTION | DES MOINES, IOWA

Welcome to the 36th Biennial LWML Convention!

Welcome to the Lutheran Women's Missionary League (LWML) Convention 2015! We are gathering as an organization that exists because of our fervent gratitude for the Savior's dying love and His blood-bought gift of redemption. We serve Him wherever He leads us.



I have been blessed to visit several of our LWML Mission Grant recipients and saw firsthand what our mighty mites can do. At this convention, we will all be blessed as our Mites in Action speakers share how LWML mite dollars have impacted the spreading of the Gospel through their organizations. We will also hear from LCMS international missionaries from Kenya and the Dominican Republic.

So again, I welcome you! I'm so very happy you are here! May our Lord bless you as together we celebrate: "Bountiful! Sow • Nourish • Reap".

I pray that nourished by God's Word, you will leave this convention empowered by the Holy Spirit to share bountifully the Father's love.

Kay Kacklauer
LWML President

Welcome to Des Moines! For the past two years the LWML Host Committee has continually commented "We'll see you in Des Moines! — at the national LWML Convention!" Those two years passed quickly and here we are, in Des Moines — at convention! The convention theme is "Bountiful! Sow • Nourish • Reap". The Lord has been bountiful as He provided the LWML women and men in the host districts of Iowa East and Iowa West with what they needed to reach this time of hosting the convention.

We spent time meeting, planning, delegating, sowing the seeds of advertising, encouraging each other, and talking up the convention with lots of excitement. God has been bountiful. He opened doors so that His bountiful Word can be sown during convention and hearers can be nurtured and encouraged in the Word. Iowa doesn't exactly have mountain tops; however, we pray you have a "mountain-top-experience," nonetheless, right here in Des Moines. As the convention unfolds, you will be inspired by an uplifting communion worship service, hear from past mission grant recipients, and be nourished by the Bible study leader, keynote speaker, and special luncheon speakers.



The typical business of the LWML will also be conducted as the delegates vote on the next biennium's mission grants. Humorous interruptions and inspiring songs will add to our convention memories. The Host Committee members are ready to serve you. If you have any questions or need assistance, please ask anyone wearing a yellow fringed scarf, brown t-shirt and khaki pants adorned with the unique Iowa badge. As convention adjourns and we leave Des Moines on Sunday, we pray you will have seen first-hand the work of the LWML in mission — in Des Moines! Thank God that He is so bountiful!

Marilyn Schroeder
Host Committee Chairman

Gifts from the Heart

Please bring Gifts from the Heart items to Meeting Room 108 on Wednesday from 5 to 8 p.m.; Thursday from 7 a.m. to 7 p.m.; and Friday from 7 a.m. to 2 p.m. Please consider volunteering to sort and pack items. Both men and women are needed: Wednesday, 5 to 8 p.m.; Thursday, 7 a.m. to 7 p.m.; and Friday, 7 a.m. to 2 p.m.



Convention Coverage

Check out our online coverage throughout the convention at www.lwml.org, and scan this QR code for live video streaming. Tell your friends back home that they too can follow along with convention proceedings.



Friday Noon Info Gatherings

The Convention Programming Committee has arranged this opportunity for all convention attendees to attend a gathering at noon on Friday, June 26. You may bring your pre-ordered box lunch or concession food with you, enjoy your meal, and then participate in one of the sessions. Most of you have already signed up for these gatherings. There might be some additional space if you would like to attend. Some are for specific groups, as noted below, and others are planned for everyone. When the room has filled to capacity, that session will be closed.

GATHERING	LOCATION
P - Clergy	CC - 301
Q - First Timers	CC - Ballroom A, 4th Level
R - Gifts of Love	CC - 312-313
S - Heart to Heart Sisters Reunion	CC - 402
T - Lutheran Church Extension Fund	CC - 306
U - Lunch with My Friends/The First Rosa	CC - 101-103 & CC - 104-106
V - Lutheran Hour Ministries	CC - 320
W - Social Media	CC - 307-310
X - The Time is NOW	CC - Ballroom B, 4th Level
Y - Thrivent Financial "Retire Wisely"	CC - 315-316
Z - YWRs and YWR Alums	CC - 401

LCEF, Lutheran Hour Ministries, Thrivent Financial Info Gatherings

Lutheran Church Extension Fund (LCEF). Ministries empowered through LCEF are a continuous circle of relationships built, believers energized, and communities served. Join with us to learn how to widen the circle, ensuring more people will hear the life-saving Gospel message and know God's everlasting love.

Lutheran Hour Ministries – Evangelism and Mission for the 21st Century. Kurt Buchholz, Executive Director of Lutheran Hour Ministries, will discuss how the organization is using mass media, outreach training, and local partnerships to reach new audiences around the world with the Gospel message.

Thrivent Financial "Retire Wisely". Back by popular demand! This interactive session will help you answer the following questions: Will I have enough to retire? Will my retirement income last? Are my assets protected? Manage six key risks all retirees face: outliving their income, inflation, unpredictable events, market volatility, income taxes, and rising healthcare costs. Turn retirement concerns into confidence. Get positive, professional guidance from a faith-based organization that has been helping our member-owners be wise with money and live generously for more than 100 years. Presented by Raeann Kusch, Wealth Advisor.

Lunch with My Friends — "The First Rosa" Friday Noon Gathering

Be one of the first people to view "The First Rosa," the untold story of Rosa Young, a Lutheran educator and church planter. Rosa Young started a spiritual revolution with her mission work in Alabama during the early 1900s. This film shows the impact Rosa had as she proclaimed the Gospel of Jesus Christ. The film will be shown on Level One in rooms 104-106.

Registration

Registration is located on the second level of the convention center at the pre-function corridor, on the south end.

Registration hours:

Wednesday, June 24, 5 to 8 p.m.

Thursday, June 25, 7 a.m. to 7 p.m.

Friday, June 26, 7 a.m. to 2 p.m.

Saturday, June 27, 8 a.m. to 2 p.m.

Entertainment Passes

Non-registered guests may purchase passes for just \$10 each at the registration desk for Saturday evening's Jan Struck and Dr. Dina Vendetti's presentation.

The desk is open from 8 a.m. to 2 p.m. on Friday and Saturday. Cash and checks only.

Where Do We Dine?

Here are the choices you have selected if you have pre-registered for meals:

Box Meals (*Thursday dinner available beginning at 4:00 p.m., and Friday lunch available beginning at 11:30 a.m.*) will all be available for pick up in the Third Level near the escalator. For those who are meeting on the First Level, your boxed meal will be available on the First Level in the escalator corridor. You can then take your meal to a meeting/caucus room, enjoy it outdoors, or eat in Rooms 101-103 or Rooms 104-106 on Friday noon.

Friday and Saturday Dinners will be plated meals served in the Grand Ballroom, located on the Fourth Level, at round tables of 10. Seats cannot be saved. Therefore, please enter the dining area with your entire group and follow the directions of the hostesses.

Saturday Invitation-Only Dinners: See the Locator for the location of the dinner. There will be signs and hostesses to direct you to the appropriate rooms.

Saturday Special Interest Luncheons: See the Locator for the location of the Special Interest Luncheon you are attending. There will be signs and hostesses to direct you to the appropriate rooms.

Box Lunches (*Sunday lunch available beginning at 11 a.m.*) will be available for pick up in the Second Level Corridor, outside of the Assembly Hall. You can then take your meal to your bus, enjoy it outdoors, or eat in your hotel room.

You must have your convention badge to receive your meals at any location.

Here are other options for those not pre-registered for meals.

Food Concessions: Concession stands, located throughout the convention center, are available the entire time of the convention on the Second and Third Levels. Exhibit Hall Concessions are available during Exhibit Hours only. The Principal River's Edge Restaurant located in Wells Fargo Arena on the Skywalk Level will also be open Thursday, Friday, and Saturday.

Area Restaurants are located within walking distance or within a few miles of the convention center. A list of Des Moines restaurants is available in your convention packet and at the LWML Information Booth.

District Caucus Locations Thursday, June 25, 2015

4:10 p.m. to 5 p.m.

Atlantic.....	317
Carolinas/Chesapeake.....	310
Eastern.....	318
Florida-Georgia.....	319
Gulf States.....	333
Indiana.....	104-106
Iowa West.....	101-103
Michigan.....	304-305
Mid-South.....	309
Minnesota North.....	307
Missouri.....	302-303
New England.....	320
North Wisconsin.....	314-315
Oklahoma.....	308
Oregon.....	301
Rocky Mountain/Montana/Utah-Idaho/ Wyoming.....	312-313
Southern Illinois.....	316
Texas.....	306

5:10 p.m. to 6 p.m.

California-Nevada-Hawaii.....	317
Central Illinois.....	310
English.....	318
Iowa East.....	101-103
Kansas.....	312-313
Louisiana-Mississippi.....	320
Minnesota South.....	104-106
Nebraska North.....	307
Nebraska South.....	302-303
New Jersey.....	333
North Dakota.....	306
Northern Illinois.....	308
Ohio.....	319
Pacific Southwest.....	316
SELC.....	301
South Dakota.....	314-315
South Wisconsin.....	304-305
Washington-Alaska.....	309

NOTE: Those who have pre-registered for meals may pick up the **Thursday Box Dinner** at the time of their caucus. Those assigned to first level rooms pick up on first level. All others pick up on the third level, Grand Concourse, East end. For those districts that have their caucus from the 4:10 p.m. to 5 p.m. time frame, please pick up your box dinner and proceed to your caucus room. Those districts that have district photos first, you are asked to wait until your caucus begins between 5:10 p.m. to 6 p.m. to pick up your box dinner. **You must be wearing your name badge to receive your Box Dinner.**

District Photo Schedule

District Photos will be taken in groups on Thursday, June 25, in three locations, two on the west end of the third floor (Memorial Hall, west end of the Grand Concourse) of the convention center and one on the mezzanine level (accessible from Memorial Hall).

DIRECTIONS: Note the locations for your district and the map in your convention packets for easy-to-follow directions. Please arrive 10 minutes before your district photo is scheduled – then smile, showing the joy of the Lord! **Group 1, align on south side of Memorial Hall Corridor; Group 2, align on north side of Memorial Hall Corridor; Group 3, take the south stairs to Mezzanine Level. Host volunteers will be available to assist you.**

GROUP 1 - Memorial Hall West - South Side

4:10 p.m. South Dakota
4:20 p.m. Kansas
4:30 p.m. Minnesota South
4:40 p.m. Nebraska South
4:50 p.m. Central Illinois
5:00 p.m. Iowa East
5:10 p.m. Indiana
5:20 p.m. Iowa West
5:30 p.m. Michigan
5:40 p.m. Missouri
5:50 p.m. North Wisconsin
6:00 p.m. Texas
6:10 p.m. Minnesota North
6:20 p.m. YWRs

GROUP 2 - Memorial Hall West - North Side

4:10 p.m. Ohio
4:20 p.m. North Dakota
4:30 p.m. Nebraska North
4:40 p.m. Northern Illinois
4:50 p.m. Pacific Southwest
5:00 p.m. South Wisconsin
5:10 p.m. Carolinas
5:20 p.m. Florida-Georgia
5:30 p.m. Chesapeake
5:40 p.m. Utah-Idaho
5:50 p.m. Oklahoma
6:00 p.m. Rocky Mountain
6:10 p.m. Wyoming
6:20 p.m. Mid-South

GROUP 3 - Memorial Hall West - Mezzanine Level - Board Room 2

4:10 p.m. California- Nevada-Hawaii
4:20 p.m. English
4:30 p.m. Louisiana- Mississippi
4:40 p.m. New Jersey
4:50 p.m. SELC
5:00 p.m. Washington-Alaska
5:10 p.m. Atlantic
5:20 p.m. Eastern
5:30 p.m. Gulf States
5:40 p.m. New England
5:50 p.m. Oregon
6:00 p.m. Southern Illinois
6:10 p.m. Montana

The 2015 Hosting Districts, Iowa East and Iowa West, photo will be taken on Sunday, June 28, at 8:15 a.m. in Memorial Hall - West Corridor.

District Photos Information

All district photos ordered on your registration form, or on-site anytime before noon on Saturday, MUST be picked up at the District Photo Pickup and Order table outside the Convention Hall doors in the Information area to avoid an additional \$4 postage and handling fee. Any photos not picked up will be mailed and charged the \$4 fee. It's not too late to get your district photo! Stop by the District Photo table to place your order. Hours for pick up and ordering are Friday 4:30 to 7 p.m.; Saturday 8 to 9 a.m., 1 to 2 p.m., and 5 to 7 p.m.; and Sunday 8 to 9 a.m.

Recordings of Presentations

Representatives of Manna Recording & Duplication, Inc. will again record and produce CDs of major presenters. Look for their booth in Pre-Function B near the Info Tables area to order and take home your favorite speakers on CD.

Emergency Phone Number

A complimentary phone number (515-564-8100) is available for family to call the convention center and leave messages for attendees. It will be available during the hours convention is in session. They may leave you a message, and then you can return the call.

Use this in addition to your hotel phone number.

Convention Courtesy Rules

It is requested that no photos be taken during worship services and other devotional periods. ALL cell phones are to be turned off or turned to vibrate.

Since the LWML will be taking photos and videotaping gathering proceedings and activities, your registration for this event gives the LWML permission to use your image and comments in educational, informational, and promotional materials in a variety of media, including webcast and other electronic media.

Activity Locator

ACTIVITY	ROOM	LEVEL	DATE	TIME
Banner Room	CC- Assembly Hall – Corridor in Hall A/B	2nd Level	June 25–28	Entire Convention
Blood Donors	CC – Pre-function area of Grand Ballroom	4th Level	June 25	9 a.m.–3 p.m.
Bountiful Bash Block Party	CC – Exhibit Hall A	2nd Level	June 26	7–9 p.m.
Child Care/Youth Activities Camp Insta Friends	CC – Board Room 1, 2, 3, 4	Mezzanine Level	Friday and Saturday June 26–27	8 a.m.–5 p.m.
Choir Rehearsal	CC – Assembly Hall – Right front on risers	2nd Level	June 25	12:30–2:30 p.m.
Choir Sign-In	CC – Info Tables, Pre-function B Corridor	2nd Level	June 24–25	Registration Hours until June 25, 12:30 p.m.
Communication Room	CC – Business Center	2nd Level	June 25–28	Entire Convention
Concessions	Starbucks	3rd Level	June 24–28	Wed. p.m. through convention
	Skywalk Concessions	3rd Level	June 25–27	11 a.m.–2 p.m. and 5–7 p.m.
	Pre-function Exhibit Hall B	2nd Level	June 26–28	Entire Convention
	River’s Edge Restaurant	3rd Level access to Wells Fargo Arena	June 25–27	11 a.m.–2 p.m.
	“Field of Bounty” Exhibit Area	2nd Level, Exhibit Hall A	June 25–27	When Exhibits are open
Convention Sessions	CC – Assembly Hall, Hall B & C	2nd Level	June 25–28	Entire Convention
Convention Shirt Sales	CC – Info Tables Pre-function B Corridor	2nd Level	June 25–27	Entire Convention
CPH Bible Study	CC – 315	3rd Level	June 26–27	6:45–7:45 a.m.
Delegate Orientation	CC- Assembly Hall, Hall B & C	2nd Level	June 25	2:30–4 p.m.
District Caucuses	CC – See <i>Bountiful! Harvest Times</i>	1st & 3rd Levels	June 25	4–6 p.m.
District Photos	CC– Memorial Hall - West. See <i>Bountiful! Harvest Times</i>	3rd Level	June 25	4:10–6:20 p.m.
District Treasurers LCEF Breakfast – (By Invitation Only)	CC– 301	3rd Level	Saturday, June 27	7–8:30 a.m.
Exhibits and LWML Store	“Field of Bounty” Exhibit Area - CC, Exhibit Hall A	2nd Level	Thursday, June 25 Friday, June 26 Friday, June 26 Saturday, June 27 Saturday, June 27	9 a.m.–6 p.m. 11:30 a.m.–2 p.m. 7–9 p.m. 7:30–9 a.m. 11:30 a.m.–2 p.m.
First Aid Room	CC - Pre-Function Area near Hall A	2nd Level	June 25–28	Entire Convention
	CC - East Grand Concourse	3rd Level	June 25–28	Entire Convention
Friday Lunch Info Gatherings P - Clergy Q - First Timers R - Gifts of Love Ministry S - Heart to Heart Sisters Reunion T - Lutheran Church Extension Fund U - Lunch with my Friends “The First Rosa” Movie V - Men’s NetWork W - Social Media X - The Time is NOW Y - Thrivent Financial Z - YWRs and YWR Alums	CC- 301 CC-Ballroom A CC - 312–313 CC - 402 CC - 306 CC - 101–103 CC - 104–106 CC - 318 CC - 307–310 CC - Ballroom B CC - 315–316 CC - 401	3rd Level 4th Level 3rd Level 4th Level 3rd Level 1st Level 1st Level 3rd Level 3rd Level 4th Level 3rd Level 4th Level 3rd Level 4th Level	Friday, June 26 Friday, June 26 Friday, June 26 Friday, June 26 Friday, June 26 Friday, June 26 Friday, June 26 Friday, June 26 Friday, June 26 Friday, June 26 Friday, June 26 Friday, June 26 Friday, June 26 Friday, June 26	Noon–1:30 p.m. Noon–1:30 p.m. Noon–1:30 p.m. Noon–1:30 p.m. Noon–1:30 p.m. Noon–1:30 p.m. Noon–1:30 p.m. Noon–1:30 p.m. Noon–1:30 p.m. Noon–1:30 p.m. Noon–1:30 p.m. Noon–1:30 p.m. Noon–1:30 p.m. Noon–1:30 p.m.
Gifts from the Heart	CC - Room 108, south end, Lower Level Area	1st Level	June 24–26	Items turned in by Friday noon
Heart to Heart District Leaders Training and Heart to Heart Sisters Program	Downtown Marriott - Rooms G & H	2nd Level	Tuesday, June 23 Wednesday, June 24 Thursday, June 25	3–8:30 p.m. 8 a.m.–9 p.m. 8 a.m.–6 p.m.
Heart to Heart Saturday Dinner - (By Invitation Only)	CC - 402	4th Level	Saturday, June 27	5–7 p.m.
Information Booths	CC - Pre-Function B Corridor & Top of escalator near Skywalk Corridor	2nd Level	June 25–28	Entire Convention
		3rd Level	June 25–28	Entire Convention
Interview Room	CC - Show Office B, Pre-Function	2nd Level	June 25–28	Entire Convention

Activity Locator

ACTIVITY	ROOM	LEVEL	DATE	TIME
Lost and Found	CC - Ticketing Office South	2nd Level	June 25–28	Entire Convention
Luggage Storage	CC - Exhibit Hall A	2nd Level	June 28	8:30 a.m.–1:30 p.m.
LWML Store	“Field of Bounty” Exhibit Area, Exhibit Hall A	2nd Level	June 25–27	See Exhibit Hours
Manna Taping Services – SALES	CC - Pre-Function B near Escalators	2nd Level	June 25–28	Entire Convention
Meals – Catered/Plated Dinners	CC - Grand Ballrooms A & B	4th Level	June 26 June 27	5:30–7 p.m. 5–7 p.m.
Message Center	Pre-Function B Corridor, north of Lost and Found	2nd Level	June 25–28	Entire Convention
Mission in Motion – Pledge Walk	Begin at CC - East to Principal River Walk	Street/(2nd Level)	June 26	5–6 p.m.
Past District Presidents Saturday Dinner – (By Invitation Only)	CC - 303–304	3rd Level	Saturday, June 27	5–7 p.m.
Pastors Gathering/Robing	CC - Show Office C	2nd Level	Thursday, June 25 Sunday, June 28	Noon–10 p.m. 8 a.m.–Noon
Pledge Walk Sign In	CC - Info Tables, Pre-function B Corridor	2nd Level	June 24–26	Registration Hours
Prayer Chapel (Grace Place)	CC - 321	3rd Level	June 25–28	Entire Convention
Prayer Service	CC - Capital Square Atrium, 4th & Locust Streets	1st Level	June 25	7 a.m.
Press/Photographer Room	CC - Pre-function Corridor B	2nd Level	June 25–28	Entire Convention
Properties	CC - 311	3rd Level	June 25–28	Entire Convention
Registrar Office	CC - Registration Area, Pre-Function South	2nd Level	June 24–27	Registration Hours
Registration	CC - Registration Area, Pre-Function South	2nd Level	Wednesday, June 24 Thursday, June 25 Friday, June 26 Saturday, June 27	5–8 p.m. 7 a.m.–7 p.m. 7 a.m.–2 p.m. 8 a.m.–2 p.m.
Saturday Special Luncheons				
B - Carly Hatcher, MOST Ministries	CC - 312–316	3rd Level	Saturday, June 27	Noon–1:30 p.m.
C - Rev. Dr. James Lamb	CC - 101–103	1st Level	Saturday, June 27	Noon–1:30 p.m.
D - LCMS Mission and Missionaries	CC - 317–320	3rd Level	Saturday, June 27	Noon–1:30 p.m.
E - Rev. Dr. Tilahun Menedo, Concordia, Alabama	CC - 104–106	1st Level	Saturday, June 27	Noon–1:30 p.m.
F - Rev. Gregory Seltz	CC - Ballroom B	4th Level	Saturday, June 27	Noon–1:30 p.m.
G - Jan Struck and Dr. Dina Vendetti	CC - Ballroom A	4th Level	Saturday, June 27	Noon–1:30 p.m.
H - Gary Thies	CC - 306–310	3rd Level	Saturday, June 27	Noon–1:30 p.m.
Servant Activities Sign In	CC - Info Tables, Pre-function B Corridor	2nd Level	June 24–25	Registration Hours
Servant Connections	CC - Grand Ballroom	4th Level	June 25	9 a.m.–3 p.m.
Thrivent Special Saturday Breakfast – District Presidents and Counselors (By Invitation Only)	CC - 303–304	3rd Level	Saturday, June 27	7–8:30 a.m.
Tours Information	CC - Info Tables, Pre-Function B Corridor	2nd Level	June 25–28	Entire Convention
Transportation Information	CC Information Booth CC - Pre-function B Corridor and Top of the escalator near Skywalk Corridor	2nd Level 3rd Level	June 25–28 June 25–28	Entire Convention Entire Convention
VIP Seating	CC - Assembly Hall, right side	2nd Level	June 25–28	Entire Convention
Wheelchair Storage and Pickup	CC - East Pre-Function near North Escalators	Street	June 25–28	Entire Convention
Workers' Room	CC - 107	1st Level	June 24–28	Entire Convention
YWR & YWR Alumni Friday Noon Gathering	CC - 401	4th Level	June 26	Noon–1:30 p.m.
YWR Saturday Dinner	CC - 401	4th Level	June 27	5–7 p.m.
YWR Servant Activity	Gifts from the Heart Area - 108	1st Level	June 25–27	Registration Hours
YWR Thursday Meet & Greet	CC - 401	4th Level	June 25	3–4 p.m.

Exhibit Locator

2017 LWML Convention Salt Lake City.....	810	Lutheran Bible Translators.....	716	LWML Public Relations/Marketing.....	515 614
Alaska Mission for Christ.....	619	Lutheran Braille Workers.....	504 506	LWML Store.....	see map below
Bethesda Auxiliary.....	531	Lutheran Church Charities.....	411	LWML Structure.....	315 414
By the Way.....	310	Lutheran Church Extension Fund.....	604 606	Ministry to the Armed Forces.....	724
Camp Io-Dis-E-Ca.....	211	Lutheran Deaconess Association.....	303	Mission Central.....	511 610
Camp Okoboji.....	626	Lutheran Deaf Mission Society.....	505	Mission of Christ Network.....	215
Christian Friends of New Americans.....	821	Lutheran Family Service-Iowa.....	609	Mission Opportunities Short Term.....	625
Concordia College Alabama.....	707 709 711	Lutheran Family Services of NE, Inc.....	920	Orphan Grain Train.....	804
Concordia College New York.....	708	Lutheran Friends of the Deaf.....	718	Phil's Friends.....	611
Concordia Historical Institute.....	608	Lutheran Haven.....	305	POBLO International Ministries.....	508
Concordia Publishing House.....	see map below	Lutheran Heritage Foundation.....	918	S.I.D. Prison Ministry.....	503
Concordia Seminary.....	630	Lutheran Hour Float Committee.....	802	Shepherd's Canyon Retreat Ministry.....	403
Concordia Theological Seminary.....	916	Lutheran Hour Ministries.....	523 525 622 624	St. Paul Lutheran High School.....	307
Concordia University Nebraska.....	702	Lutheran Housing Support.....	605	The Apple of His Eye Mission Society.....	808
Concordia University Portland.....	710	Lutheran Immigration & Refugee Service.....	507 509	The Lutheran Church-Missouri Synod.....	715 717 719 721 814 816 818 820
Concordia University St. Paul.....	706	Lutheran Indian Ministries.....	602	Thrivent Financial.....	309 311 408 410
Concordia University Texas.....	704	Lutheran Special Education Ministries.....	405	Time of Grace Ministry.....	726
Concordia University Wisconsin & Ann Arbor.....	703 705	Lutheran World Relief.....	203 205 207 302 304 306	Trinity Lutheran Church.....	404
Confessional Lutheran Education Foundation.....	407	Lutherans for Life.....	714	Urban Missions-LCMS.....	308
Dakota Boys and Girls Ranch.....	806	LWML Archivist-Historian.....	517	Valparaiso University.....	502
Deaconess Program-Concordia University Chicago.....	603	LWML Christian Life Department.....	314 316 318	Voice of Care.....	527
Diana's Angels Project.....	607	LWML Committee on Young Women.....	416 418	Voice of Faith.....	529
Fishers of Men Christian Ministry-Rio Grande Valley.....	409	LWML Communication Department.....	217 219	We Must Carry On, Inc.....	209
Friends of Westfield House.....	406	LWML Gifts of Love.....	616	Wheat Ridge Ministries.....	730
Grace Place Wellness Ministries.....	629	LWML Gospel Outreach Department.....	317 319	Wittenberg Academy.....	728
Imagine Tours and Travel.....	402	LWML Heart to Heart.....	419 518	Women's Leadership Institute.....	631
International Student Ministry, Inc.....	628	LWML Hope.....	514 516	Worldwide KFEO.....	615 617
Kuwaa Mission.....	510	LWML Host Committee Photo Ops.....	Entrance	Worship for Shut-Ins/Lutheran Ministries Media, Inc.....	627
LAMP.....	819	LWML Leader Development.....	415 417		
LeadaChild/CCCS.....	817	LWML Past Presidents.....	519 618		

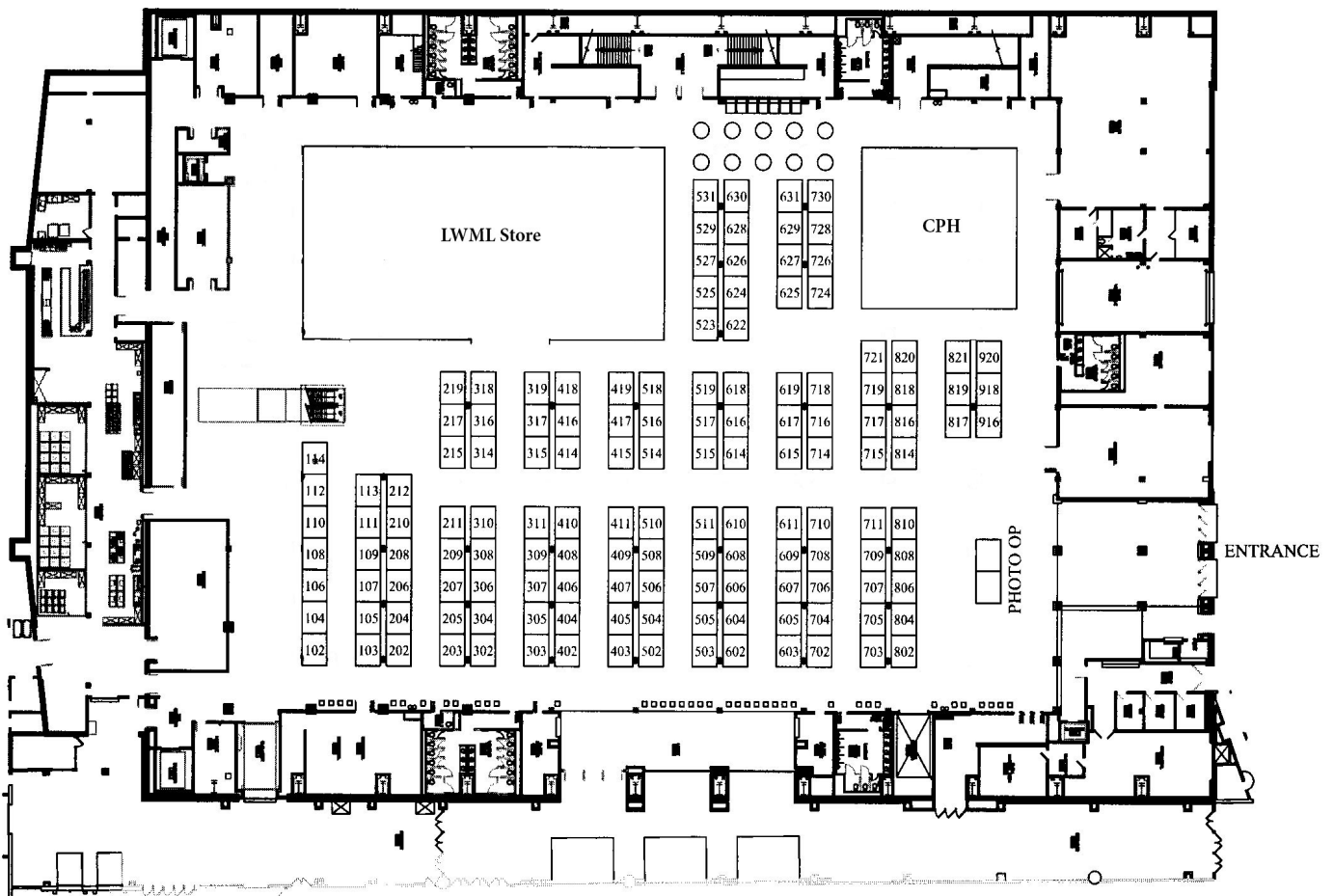

THE TIME IS *now*

The Time is NOW is an initiative to help the LWML refocus on our basic core values: being in God's Word, missions, service, and fellowship.

It is imperative, even urgent, that women share with other women the contagious joy that results from being a member of LWML. The Time is NOW to look to the future of the LWML!

Look for BIG Ideas (identified with the light bulb symbol) in each issue of *Bountiful! Harvest Times*. Discover how this initiative could be shared throughout our LWML. Go to www.lwml.org, and download the list of 75 BIG Ideas shared by members of the LWML Board of Directors. The challenge is to try to use these 75 BIG Ideas before the 2017 LWML Convention in Salt Lake City, when the LWML will celebrate its 75th Anniversary!

Begin to think outside the box and be creative. Share at least one BIG Idea with a sister in Christ today!



The Time is NOW to prayerfully remember the mission goal daily and to give Him thanks for His work done through us and these mites!



The Time is NOW to make an appointment with your pastor and share the partnership of LWML and the work of the LCMS. Equip him with resources like Pastor to Pastor so he can talk to other pastors about the work of LWML and how the women in their care can help them.



The Time is NOW to give someone a fresh flower and share how they, like the flower, are God's masterpiece and how much He loves them.

Special Communion Ware and Wine

The communion ware for our worship service was designed for this convention by From Miry Clay Pottery located in Dayton, Iowa. Tyler Sandstrom is the creative artisan behind From Miry Clay Pottery. After the opening service, a communion set will be on display in the Field of Bounty Exhibit Hall. Please stop by to see it.

Our communion wine is from Fireside Winery, located in Marengo, Iowa. The wine chosen is made from a blend of Concord and LaCrosse grapes and is named "Serenade." Fireside Winery was born in 2007 from a desire by the Wyant family to embrace the "life is too short" philosophy, a long-term passion for wine, an interest in diversifying the family farm business, and a wish to pass on their farm heritage to their children.

2015 Convention Offerings

#1 - 2015–2017 Mission Goal.

#2 - Discovering Disabilities, including ALL of God's Children. Lutheran Special Education Ministries (LSEM) Farmington Hills, Michigan. The offering will provide educational events and supportive consultation to equip congregations and/or schools to reach out and include children/families with disabilities in their Christ centered faith communities.

#3 - Cabins for Christ's Children. Lutheran Valley Retreat, Colorado Springs, Colorado. The offering will be used to

purchase materials/beds for cabins burned in the 2002 Hayman Fire.

#4 - Family of God Mission, Detroit, Michigan. Family of God Mission, a mission plant of the Michigan District in Southwest Detroit. The offering will be used to replace their 15-year-old van.

Free Shipping on Orders over \$99

Not enough room in your suitcase? From June 25–27, online LWML orders over \$99 will receive free shipping. Browse through our new eCatalog to shop at www.lwml.org/store or visit our store kiosk. Use promo code TLWM15 during checkout.

Opening Worship Service

The Thursday Opening Worship Service is open to the public. Guests may attend the Friday evening Bountiful Bash, Saturday evening entertainment, and Sunday morning worship after completing an Acknowledgment/Release Form and receiving a name tag. A donation to the mite goal would be appreciated for the Bountiful Bash.

Prayer Chapel

Come to the "Grace Place" Prayer Chapel in Room 321, on the Third Level in the convention center, to be refreshed. The Chapel will be staffed with an LWML member and a pastor, Thursday through Saturday from 8 a.m. to 6 p.m. There will be LHM and CPH tracts, Bibles, devotional materials, and Bible verse bookmarks to use as you spend this quiet time with God.

Choir

Choir rehearsal is from 12:30 to 2:30 p.m. on Thursday in the convention center, 2nd level, Assembly Hall C. Please check-in at the choir table in the Registration Area just outside Assembly Hall B before noon.

Transportation & Luggage Storage

If you are traveling by air through the Des Moines International Airport, please make arrangements at your hotel by Saturday, June 27, for a Sunday, June 28, departure. Yellow Cab service is available by calling 515-243-1111. For those who will be using hotel shuttle bus for transportation back to the airport after the conclusion of convention, it is suggested that you either ask for a late check-out time or ask if the hotel could store your luggage until you are ready to go to the airport. For those needing luggage storage on Sunday morning at the convention center, bring your luggage to Exhibit Hall A on the second level for storage and pick-up from 8:30 a.m. to 1:30 p.m.

Seating

Seating at tables on the floor near the stage area is reserved for delegates, LWML committees, program participants, and invited guests. Designations will be made for those permitted to be seated at the tables. Special seating will be provided for those who are physically or hearing challenged. Please follow the instructions of the ushers.

Because of the large number of attendees, those sitting in the general Assembly Hall are asked to move to the center and fill in every seat. Seating Thursday and Saturday evenings will be open seating, with limited reserved seating for participants.

Bountiful YWRs and H2H Sisters attend convention

Please welcome 72 Young Women Representatives (YWRs) representing 38 LWML Districts, 10 Heart to Heart (H2H) District Leaders, and 17 H2H Sister Trainees representing 10 different ethnicities. Encourage these women as they experience an LWML convention. Pray that their hearts and minds may be opened to all of the blessings our Lord has bestowed upon the LWML and, that through this experience, these women may be led to serve the Lord with gladness!

Mission in Motion

Pre-registered participants are requested to turn in their pledge sheets and donations and pick up their shirts at the Mission in Motion table, located near the registration area of the convention center. The walk will leave from the convention center, cross over Third and Second Streets, the Women of Achievement Bridge, and follow the Principal River Walk along the Des Moines River on Friday, June 26, between 5 and 6 p.m. Remember to wear comfortable clothes and bring water with you.

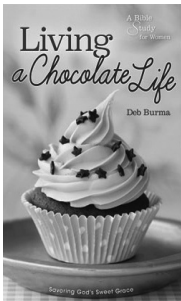

CPH Breakfast Bible Studies

Chocolate counts for breakfast, right? Start Friday in the Word with Concordia Publishing House and author Deb Burma. Deb will lead a Bible study based on

Living a Chocolate Life. Join us in Room 315 from 6:45 to 7:45 a.m.

Bring your coffee and your Bible and start Saturday in the Word with Concordia Publishing House and author Donna Pyle. Donna will lead a Bible study based on her latest book, *Quenched: Christ's Living Water for a Thirsty Soul*. Join us in Room 315 from 6:45 to 7:45 a.m.

Camp Insta Friends

Camp Insta Friends promises to be a lot of fun for the 50+ children and adults participating. Each day is packed with exciting activities, field trips, and devotions. Among the activities planned for the Primary and Intermediate groups are trips to the Science Center of Iowa and the Blank Park Zoo. The High School group will also be participating in servant event activities on both days of camp. One of their servant activities will be assisting in the food pantry, clothing closet, and garden of the Central Iowa Shelter and Services. Another will be packaging meals

for starving people around the world at Meals for the Heartland. They will also tour the Science Center of Iowa. Campers will enjoy activities at the convention center planned just for them. Camp Insta Friends is open, by pre-registration only, on Friday and Saturday at the convention center, from 8 a.m. to 5 p.m.

New LWML Book

Join Past LWML Presidents Ida Mall, Gloria Edwards, Virginia von Seggern, Linda Reiser, and Jan Wendorf for a special book signing event in the Concordia Publishing House booth during the Bountiful Bash – A Party with a Purpose!, from 7 to 9 p.m. on Friday in Exhibit Hall A “Field of Bounty.” The past presidents will be signing copies of their new devotional, *Hope Notes*. Don't miss this special opportunity to visit with the past presidents! Current LWML President Kay Kreklau also was an author.

Newsletter Publication Schedule

Four editions of *Bountiful! Harvest Times* will be published during this convention. Here is a breakdown of what to expect in each issue.

Thursday, Issue #1: Pre-convention news, schedules, site map, BIG Ideas to engage women in The Time is NOW, and general information.

Friday, Issue #2: Highlights of the day's special events, additional BIG Ideas, exciting details of the evening's action-packed, interactive Bountiful Bash event.

Saturday, Issue #3: Highlights of the day's special events, additional BIG Ideas, last call to visit the LWML committees at their booths and be inspired with new ideas to take home.

Sunday, Issue #4: Post-convention expanded edition. All the news in one handy location, including results of mission grant voting, election of officers, totals from Gifts from the Heart, the LWML President's report, summaries of guest speakers and Bible studies, BIG Ideas, post-convention devotion, photos, and more!

Servant Connections

Don't miss this opportunity to catch up with friends while serving our Lord and helping others. You have ten opportunities to serve including: blood donations, card making, marking Bibles for prison ministry, packing meals for “Kids Against Hunger”, assembling a book of the Bible in Braille, and making Gospel bracelets, plastic bag mats, lap robes, fleece blankets, pillow case dresses, and quilts. WOW! What an opportunity to serve! Plan to take part at your pre-assigned times on Thursday in the Grand Ballroom, 4th Level of the convention center, 9 a.m. to 3 p.m.

The new LWML Outreach Bible

Introducing the new LWML Outreach Bible! This new

LWML *Today's Light® Devotional Bible* was specifically designed as an outreach Bible.

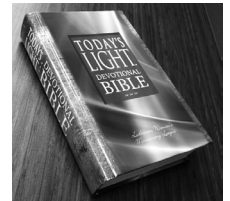

“Our prayer is that it will be purchased

specifically to give to someone, sharing with them our love for God's Word and the gift of His redeeming love for all people,” LWML President Kay Kreklau declared.

On the back cover, these words reach out to those who need Jesus: “You hold in your hands God's Word, and a most wonderful guide to help you in your daily walk with the Lord”. On the inside cover of this Bible, users will find a brief order for worship they may choose to use as they spend time with the Lord. Luther's Morning and Evening Prayers and the Lord's Prayer are printed on the back cover for further comfort and guidance. This Bible may be purchased at the LWML Store.

Unsung Heroes in Procession

The Saturday morning procession will once again include unsung heroes from every district. Each district president has selected one woman from her district who has given selflessly to the LWML without recognition to join today's procession.

The *Bountiful! Harvest Times* is published four times during convention by the LWML Communication Department.

Vice President of Communication Nancy Bogenhagen
 Newspaper Editor Pam Knepper
 Graphic Designer Pam Knepper
 Quarterly Editor-in-Chief Nancy Graf Peters
 Quarterly Associate Editor Beth Foreman
 Contributors Cheri Fish, Amy Gill, Pam Knepper,
 Sheila Lutz, Sharon Rapp, and LWML committee members