

ROCK Solid News

32nd Biennial LWML Convention ~ Sioux Falls, South Dakota

June 21, 2007

Issue 1

Welcome to South Dakota!

Welcome to Sioux Falls, South Dakota! Welcome to this 65th Anniversary Celebration of the LWML! Welcome to the 32nd Biennial Convention of the Lutheran Women's Missionary League!

Whether this is your first convention, your 2nd or your 10th, I know you will have a life-enhancing experience in the next few days. From our Opening Worship where we are fed with God's Word and His Sacraments, to our Bible studies and speakers, you and I will be enriched daily.

As you experience the convention, I encourage you to let Sioux Falls know the love of Jesus through your interaction with this community. As we leave this place to go home in just a few days, may your life reflect what you have heard, seen, experienced and done as a result of your time spent at this convention.

The Lutheran Women's Missionary League celebrates 65 years as an organization at this convention. That is significant and yet what is truly more significant is the difference each one of you individually makes daily as you pray for the missionaries, the mission grants and as you involve yourself in service to others because of your love of Jesus and His love for all people.

As this is my final convention to serve as your president, I thank you for the privilege you gave me to humbly serve my Lord and this organization. This convention, like the 31 before will be a time of joy and celebration as sisters in Christ select a new mission goal, new mission grants to prayerfully and financially support and elect new officers. It will also be a time to celebrate the blessings God has given to the LWML as we focus on missions, spiritual growth opportunities, service and Christian fellowship for women.

May your convention experience be one of great joy! May the convention goal be your goal, "Secure in Jesus, my rock and fortress, I step out in faith to declare His praise and serve others."

Linda Reiser, President
Lutheran Women's Missionary League



The 2007 LWML Convention Host Committee is delighted to welcome you to South Dakota! Over 500 men, women and teens have been working diligently to prepare for you. We offer you a ROCK solid guarantee that the convention will leave you secure in God's love, celebrating Jesus and ready to boldly and confidently share the Gospel message!

You will find Host Committee workers dressed in the convention polo and a green apron. We are here to *serve* you and want your convention experience to be the best it can be. If we can help in any way, please ask.

While you will not want to miss any convention activities, we encourage you to spend some time in our pleasant city. Sioux Falls offers a wide variety of fascinating attractions from museums and galleries to gardens and performing arts. Tour downtown, the Sculpture Walk and Falls Park on the (1890 street car replica) trolley.

We recommend shopping at the Outdoor Campus, the Washington Pavilion, the Old Courthouse Museum and East 8th Street. Try some of our many ethnic restaurants and the Sioux Falls Originals. Information about attractions and restaurants is available at the Information Desk or at your hotel. Everything is just minutes away!

"Secure in Jesus, my rock and fortress, I step out in faith to declare His praise and serve others." We are privileged to join you in enjoying the convention, being inspired by the theme and in declaring His praises every day of our lives! We are honored to host you in Sioux Falls. Thanks for coming.

Pat Reichert
Host Committee Chairman

Gifts from the Heart

YOU SAW the information in the registration material. YOU GATHERED items and packaged them for the trip. YOU GAVE from your Heart. NOW YOU CAN BRING the Gifts from your Heart with you when you register. Tables are set up next to the registration area, and workers will be there to receive your gifts during registration hours until noon on Friday.

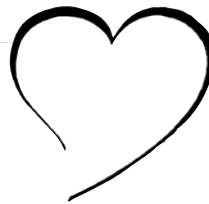

Choir Rehearsal

Welcome to all choir members! Rehearsal is 12:30–2:30 p.m. on Thursday. Please check-in at the choir tables in the Arena lobby beginning at 11:00 a.m. Rehearsal begins promptly at 12:30 p.m.

Seating

Seating at tables on the floor of the Arena is reserved for delegates, LWML committees, program participants and invited guests. Special seating will be provided for those who are physically or hearing challenged. Please follow the instructions of the ushers.

Because of the large number of attendees, please move to the center of the rows and fill in every seat.

Seating on both Friday and Saturday evening will be delegate seating on the floor. See information about seating for the Thursday night worship service to the right.

Evaluation Survey

In your convention packet you will find a magenta and white survey form. **Please mark this survey form and return by the end of convention.** You may return this form to an usher or place it in a box marked “**Convention Evaluation Surveys**” located in the arena lobby, the rear of the arena floor or the Convention Center Information Booth.

Please do not fold the form or write on the front of the survey. You may add comments on the back or on additional paper. Thank you for taking time to evaluate your convention experience.

Manna Taping

Manna Recording and Duplicating Co. of Albuquerque, N.M., will again be present at our convention and will make available audiotapes and CDs of the convention presenters for purchase. They will be located in the convention center corridor close to the arena entrance. Stop by their table for an order form and greet Nicole Tucker of Manna taping!

Overflow seating planned for service

Everyone is welcome to attend the Thursday evening worship service beginning with pre-service music at 6:45 p.m. Convention registration is NOT required.

Overflow seating is planned for 800 with a large screen, sound and communion stations.

Doors of the arena will be opened at 6:00 p.m. on Thursday evening for women and men who have nametags as registered guests of the convention. At 6:30 p.m. the arena will be

open to all guests coming for the Worship Service.

There CANNOT be saving of seats. If you plan to sit together, come together. Please help by moving to the center of the rows, filling in every seat and letting ushers know where space is still available.

If you plan to be with guests who are not registered for convention, but just attending the Opening Worship Service, it is suggested you go directly to the overflow area.

Convention DVD

Each full registrant will receive a complimentary convention DVD in the mail in September. The DVD will contain the highlights of the convention and a complete list of the new mission grants selected for the 2007-09 biennium.

EXTRA! EXTRA!

If you have newsworthy items or interesting tidbits to share for the daily newspaper, please drop your articles in the box located in Room 6 by 3:00 p.m. each day.

Cyber Spot

Need to check your e-mails while you're away? Come to the CyberSpot in Room 6 where you can do that and more! Explore our Web site at www.lwml.org or let your fingers do the shopping at our new online LWML Store. Receive a coupon good for a free gift with any online purchase! The CyberSpot will be open during regular exhibit hours. Come check it out!

Camp

Record numbers of campers have signed up to participate in Camp ROCK activities! At the Convention Center, all campers will enjoy age-appropriate Bible studies or stories, crafts, games, snacks and special entertainment, supervised by caring volunteers. Camp ROCK is open by pre-registration only on Friday and Saturday in Convention Center Rooms 13 and 14.

Nursery- and toddler-aged campers will remain on site in the care of experienced caregiv-

ers. Bible stories, videos, songs, snacks, games, playtime and naps are planned.

Primary-aged children will visit the Washington Pavilion and Terrace Park Aquatic Center on Friday. On Saturday they will experience the Butterfly House and Great Plains Zoo. The oldest group of campers visits the zoo and Outdoor Campus on Friday and the Aquatic Center and Washington Pavilion on Saturday. Transportation, admission, lunch and chaperones are included.

Calling All Rock Hounds!

If you like to search for treasure, you, too, can be a certified Rock Hound. In your registration packet is a Rock Hound Passport. To be certified, you will need to visit all nine LWML department/committee booths (eight in the Exhibit Hall and one in Room 6), learn what gems our committees have for you, and get a stamp or signature from each.

When you have all nine spaces filled in, take your passport to the exhibit hall hostess table near the doors. A hostess will give you a paper for your name and district and then drop it in the box for the

drawing.

Each day of the convention (Thursday, Friday and Saturday) after the close of exhibits, an entry will be drawn and that person will receive Sue Falls, the convention bear, and a \$25 gift certificate good at the LWML Store.

The name drawn at the close of Saturday's exhibit hours will be able to use the certificate for purchases through the *LWML Catalog*.

Each winner will be announced in *ROCK Solid News* the following morning. Prizes can be claimed at the registration desk.

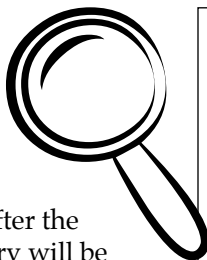

Registration Hours

Wednesday 5:00 p.m. – 8:00 p.m.
 Thursday 7:00 a.m. – 7:00 p.m.
 Friday 7:00 a.m. – 2:00 p.m.
 Saturday 8:00 a.m. – 2:00 p.m.

Exhibit Hours

Thursday 10:00 a.m. – 6:00 p.m.
 Friday 11:30 a.m. – 2:00 p.m.
 5:00 p.m. – 7:00 p.m.
 Saturday 8:00 a.m. – 9:30 a.m.
 11:30 a.m. – 2:00 p.m.

Prayer Chapel Hours

Thursday 9:30 a.m. – 6:30 p.m.
 Friday 8:00 a.m. – 7:30 p.m.
 Saturday 8:00 a.m. – 7:30 p.m.

King's Servants ROCK!

Record numbers will participate in King's Servant Activities. Participants will build garden sheds for Habitat for Humanity/Thrivent Builds and sort and pack clothing for Orphan Grain Train. Both of these activities take place in two tents in the north entrance parking lot.

Marking Bibles for prison ministry, making cough pillows for post-operative heart patients, finishing quilts, writing letters to missionaries and making baptismal banners for Native American Missions across the U.S. all happen in Ballroom A of the Convention Center.

Some volunteers will roll up their sleeves and donate blood for the Community Blood Bank of Sioux Falls in two mobile units in front of the Convention Center.

You will want to tour the Habitat for Humanity/Thrivent Builds mobile unit in the north entrance parking lot throughout the day on Thursday.

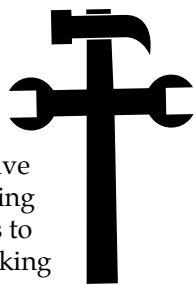

Resting Rock Café

- The Friday Box Lunch will be available in Ballroom A between 11:30 a.m. and 1:30 p.m.
- Friday and Saturday evening dinners will be served in Ballroom A & B between 5 and 6:30 p.m. each evening.
- You must have your convention badge to pick up box lunches and enter the Resting Rock Café.
- Please enter with your entire party. Seats cannot be saved.

Concession Food

Concession stands open in the Convention Center starting Wednesday and in the Arena starting Thursday. A list of area restaurants is available at the LWML Information Desk and Hotel Hostess Desk.

Rockin' Trail

Pre-registered walkers should stop at the Rockin' Trail table located in Room 7 of the Convention Center during registration to turn in Mission Pledge Walk sheets and checks and pick up walk shirts and directions to Howard Wood Field. Two opportunities to walk are offered: Saturday from 6:30–8:30 a.m. and Saturday from 12:00 p.m.–1:30 p.m.



Emergency Number

A complimentary phone number (605-367-4114) is available for family members to call the convention center and leave messages for attendees. It will be available during the hours convention is in session.

Convention Courtesy Rules

It is requested that no photos be taken during worship services and other devotional periods. AND all cell phones are to be turned off or turned to vibrate.

Since the LWML will be taking pictures and videotaping gathering proceedings and activities, your registration for this event gives the LWML permission to use your image and comments in educational, informational and promotional materials in a variety of media, including electronic media.

Activity Locator

ACTIVITY	ROOM	LEVEL	DATE	TIME
Banner Room	Arena left floor level	Floor	June 20 – 24	Entire Convention
Blood Donors	Convention Center # 7	Street	June 21	9:00 a.m. – 3:00 p.m.
Child Care/Youth Activities Camp ROCK	Convention Center # 13 and # 14	Street	June 22 – 23	8:00 a.m. – 5:00 p.m.
Choir Rehearsal	Arena left upper level	Upper	June 21	12:30 p.m. – 2:30 p.m.
Choir Sign-In	Arena lobby	Floor	June 21	11:00 a.m. – 12:30 p.m.
Concessions	Arena concourse Convention Center Prairie Park Exhibit Area	1st & 2nd Street	June 21 – 24 June 20 – 24	Entire Convention Entire Convention
Convention Sessions	Arena	All	June 21 – 24	Entire Convention
Convention Shirt Sales	CC - Main Lobby	Street	June 20 – 24	Entire Convention
CyberSpot	Convention Center # 6	Street	June 20-23	Exhibit Hours
Delegate Orientation	Arena	Floor	June 21	3:00 p.m. – 4:00 p.m.
Exhibits and LWML Store	Prairie Park Exhibit Area Convention Center	Street	Thursday, June 21 Friday, June 22 Friday, June 22 Saturday, June 23 Saturday, June 23	10:00 a.m. – 6:00 p.m. 11:30 a.m. – 2:00 p.m. 5:00 p.m. – 7:00 p.m. 8:00 a.m. – 9:30 a.m. 11:30 a.m. – 2:00 p.m.
First Aid Room	Arena lower left	Floor	June 21 – 24	Entire Convention
Gifts from the Heart	Convention Center Near Room # 10	Street	June 20 – 22	Until 12:00 p.m. Friday
Heart to Heart Sisters Program	Convention Center # 12 Fontenelle A (Sheraton)	Street Street	June 20 June 21 June 21	4:00 p.m. – 8:00 p.m. 7:30 a.m. – 4:00 p.m. 4:30 p.m. – 6:00 p.m.
Information Booth	Convention Center Main Lobby	Street	June 21 – 24	Entire Convention
King's Servants	Convention Center Ballrooms A & B Arena North Parking Lot	Street	June 21	9:00 a.m. – 3:00 p.m.
Lost and Found	Convention Center # 2	Street	June 21 – 24	Entire Convention
<i>Luncheons by Invitation Only</i> Heart to Heart First Timers Teen LWML YWR Past District Presidents MMV District Counselors	Fontenelle A (Sheraton) CC # 11 & 12 CC # 7 Fontenelle A (Sheraton) CC # 11-12 CC # 7 CC # 8	Street Street Street Street Street Street Street	Friday, June 22 Friday, June 22 Friday, June 22 Saturday, June 23 Saturday, June 23 Saturday, June 23 Saturday, June 23	12:00 p.m. – 1:30 p.m. 12:00 p.m. – 1:30 p.m. 12:00 p.m. – 1:30 p.m. 12:00 p.m. – 1:30 p.m. 12:00 p.m. – 1:30 p.m. 12:00 p.m. – 1:30 p.m. 12:00 p.m. – 1:30 p.m.
LWML Store	Prairie Park Exhibit Area		June 20 – 23	See Exhibit Hours, p. 3
Manna Taping Services – SALES	Conv Center near Arena	Street	June 21 – 24	Entire Convention
Meal Package	Resting Rock Café Ballrooms A & B	Street	June 22 – 24	Entire Convention
Media and Press Room	Convention Center # 6	Street	June 21 – 24	Entire Convention
Message Board	Convention Center Near Information Booth	Street	June 21 – 24	Entire Convention
Mission Pledge Walk – Rockin' Trail	Howard Wood Field	Behind CC	June 23	6:30 a.m. – 8:30 a.m. 12:00 p.m. – 1:30 p.m.

Activity Locator Continued on Next Page

Activity Locator

ACTIVITY	ROOM	LEVEL	DATE	TIME
Pastors Gathering/Robing	Arena right floor level Pastors' Room	Floor	Thurs., June 21 Sun., June 24	12:00 p.m. – 10:00 p.m. 8:00 a.m. – 12:00 p.m.
Pledge Walk Sign-In	Convention Center # 7	Street	June 21 – 22	Registration Times
Prayer Chapel	Convention Center # 4	Street	June 21 – 24	Entire Convention
Properties	Convention Center #1	Street	June 21 – 24	Entire Convention
Registrar Office	Registration Area	Street	June 21 – 23	Registration Times
Registration	Registration Area Convention Center Rooms # 8,9,10	Street	Wed., June 20 Thurs., June 21 Fri., June 22 Sat., June 23	5:00 p.m. – 8:00 p.m. 7:00 a.m. – 7:00 p.m. 7:00 a.m. – 2:00 p.m. 8:00 a.m. – 2:00 p.m.
Servant Activities Sign In	Convention Center # 7	Street	June 20 – 21	Registration Hours
Teen Gathering	Conv Center # 11 & 12	Street	June 23	3:30-4:45 PM
Tours Information	CC Information Booth	Street	June 21 – 24	Entire Convention
Transportation Information	CC Information Booth	Street	June 21 – 24	Entire Convention
Wheelchair Storage and Pickup	Convention Center # 2	Street	June 21 – 24	Entire Convention
Workers' Room	Convention Center # 3	Street	June 20 – 24	Entire Convention
YWR Friday Noon Gathering	TBA	TBA	June 22	12:00 p.m.
YWR Thursday Get-together	Convention Center # 11	Street	June 21	4:30 p.m. – 6:30 p.m.
YWR Servant Activity	Gifts from the Heart Area	Street	June 20 – 21	Registration Hours

Sioux Falls Convention Center

Refer to Locator above for Room Assignments

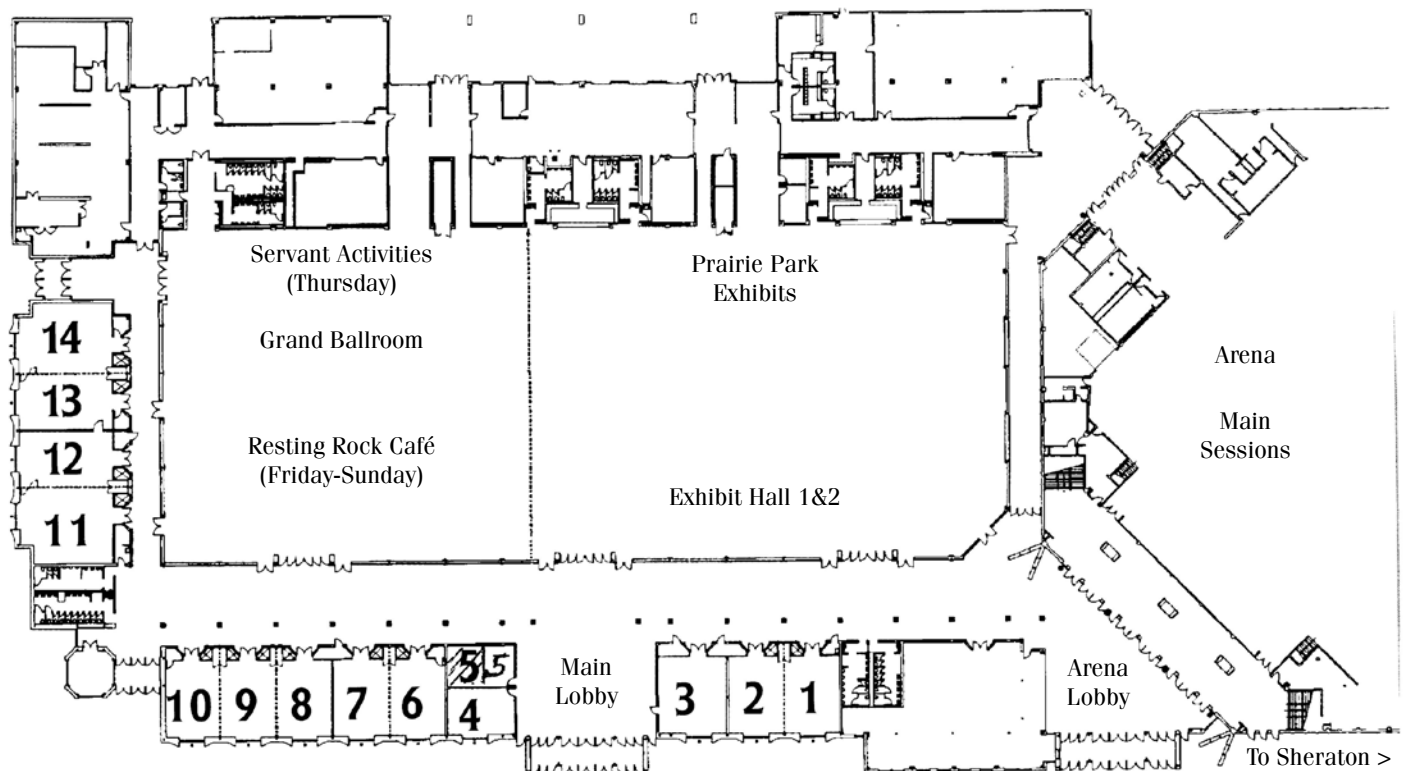
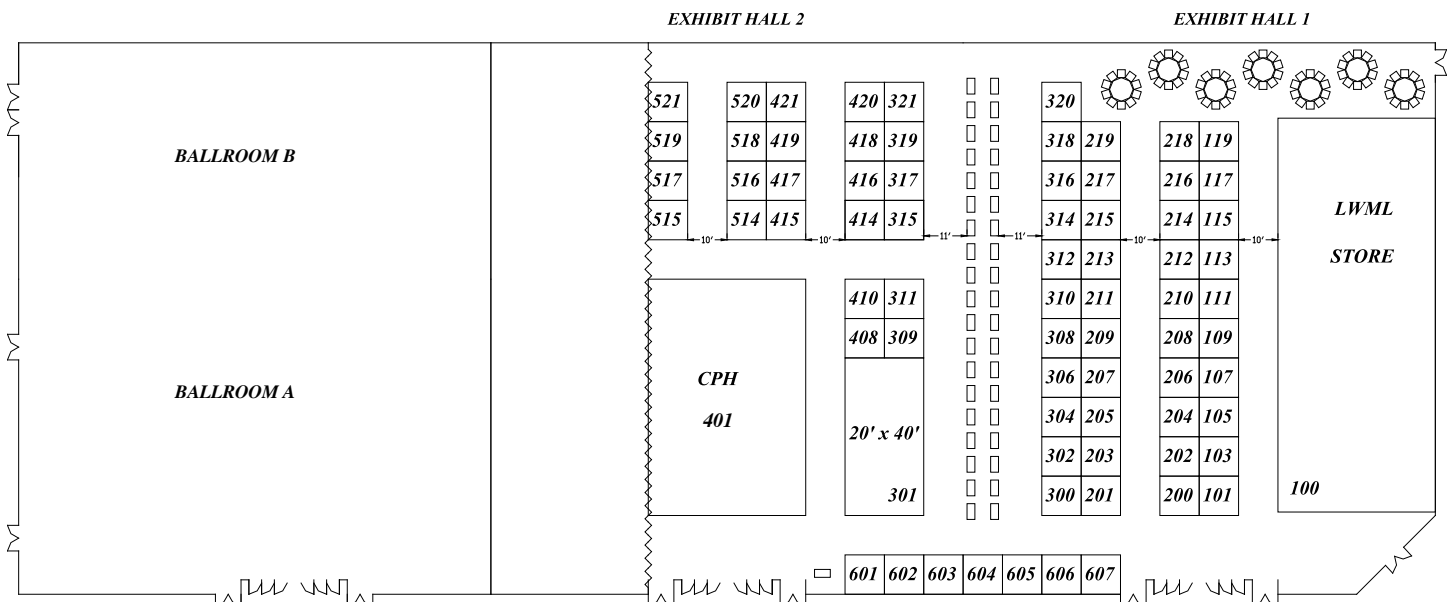

Exhibit Locator

Organization	Booth #	Organization	Booth #
Archivist-Historian	515, 517	Lutheran Campus Mission Association.....	105
Bethesda Lutheran Home and Service.....	516	Lutheran Church Extension Fund	217, 219
Children’s Christian Concern Society (CCCS).....	218	Lutheran Deaconess Association	107, 109
Christian Life Department	111, 113, 115	Lutheran Evangelism Association.....	200
Concordia Publishing House	401	Lutheran Heritage Foundation	521
Concordia Seminary	203	Lutheran Hour Float Committee	416
Concordia Theological Seminary.....	214	Lutheran Hour Ministries.....	215
Concordia University Austin	211	Lutheran Immigration and Refugee Service.....	119
Concordia University Chicago.....	310	Lutheran Special Education Ministries.....	314
Concordia University System		Lutheran World Relief	419, 421, 518, 520
“For the Sake of the Church”	304	Lutherans For Life.....	213
Concordia University, St. Paul	605	LWML — Portland 2009.....	312
Dakota Boys and Girls Ranch.....	604	LWML Past Presidents and	
Deaf Lutheran Missions	216	Gift Planning Counselor	101, 103
Friends of Mercy	514	LWML Store	100
Good Samaritan Communities of Sioux Falls.....	306	MOST Ministries	208
Gospel Outreach Department	207, 209	Ongoing Ambassadors for Christ.....	117
HOPE Committee.....	316, 318	Orphan Grain Train	519
Host Committee	601	Peace Officer Ministries, Inc.	206
Human Care Department	210, 212	Project 12 Baskets	417
ISM, Inc.	202	St. Paul Lutheran High.....	204
LAMP.....	201	Structure Committee.....	302
LCMS World Mission	301	Teen Task Force.....	315, 317
LCMS World Relief and Human Care.....	309, 311, 408, 410	The African Christian Mission Society.....	320
LCMS/Black Ministry	415	Thrivent Financial for Lutherans.....	606, 607
Leader Development Committee/YWR.....	418, 420	Wheat Ridge Ministries.....	205
Lutheran Assoc. of Missionaries & Pilots U.S.....	602	Women’s Leadership Institute	
Lutheran Bible Translators.....	319, 321	of Concordia University Wisconsin.....	308
Lutheran Blind Mission.....	300	Worldwide KFYO Radio.....	603
Lutheran Braille Workers.....	414		



See Exhibit Hours on Page 3

“For you a rose ...”

... is waiting at the Portland Oregon Visitors' Association booth in the Prairie Park Exhibit Hall. Stop by and learn about all of the wonderful things there are to see and do in Portland when you come to the LWML convention in 2009.

Bring your family — there's something for everyone! Plan to come early and stay after the convention to tour all of the sights in and around Portland — rose gardens, the zoo, the Oregon Museum of Science and Industry (OMSI), microbreweries, wine country... There's simply too much to see and do in just a day or two!

We're **beautiful!** We're **friendly!**
We're **green** — and every other color of the rainbow!

PORTLAND 2009
Oregon Convention Center
June 25 - 28

What's your Mission? What's your Ministry? Do you have a Vision?

If your LWML group is challenged in answering any of these questions, stop by the HOPE Committee exhibit in Prairie Park to see how a Mission-Ministry Vision (MMV) Consultant can help strengthen and focus your group!



Learn about LBT's mission & sign up for drawing

Lutheran Bible Translators will be offering LWML attendees multiple opportunities to learn more about LBT's worldwide mission, to pray for Bible-less people, and to enter daily drawings to receive authentic items from foreign countries.

LBT's mission is to help bring people to faith in Christ by making the Word of God available to those who do not

TEENS: Go Fishing!

Friends Into Serving Him and LWMLers, be sure to stop by the huge aquarium in the exhibit hall and take a swim. We need your help to fill the 'waters' with those ready to "Serve the Lord with Gladness." While you visit you can learn more about the new LWML program for teens and share stories from your teen events. No swimsuit needed!!



Test your knowledge!

Do you know where your Mite dollars are going? Do you think you have a pretty good grip on the location and nature of LWML mission grants?



Well, come on down to the Mission Advocacy and Grants/Gospel Outreach Booth in the Prairie Park Exhibit Area and take the MAG Quiz on Mission Grants! All top-scoring quiz winners will be entered in a drawing for a wonderful, OVERSIZED prize basket of great LWML products. Either way, you can't lose! You may win a prize and you will gain terrific insight into the mission of LWML and the church. The MAG/Gospel Outreach Committees can't wait to meet you and hear about YOUR mission in LWML!

ROCK On at the Christian Life Exhibit

Looking for a place to rest your feet, visit with new friends and check out what's new from the Christian Life Department? Then come on over to the "Rockin' Room" in the Prairie Park Exhibit Hall.

What a great time to relax and review the new *Mustard Seeds*; the wonderful new prayer book, *A Woman's Praying Heart*; fresh new *Program Helps*; plus new CD collections. Of course, you will want to take a look at the hot-off-the-press new *Meeting and Event Planner*, a must-have for every society.

There will be "rockin' games" to play, a new PowerPoint® program to view, plus an opportunity to creatively enhance a new *Together in Prayer* bookmark. Sign up for the drawing of a gift basket filled with new products you are sure to enjoy!

Come by the LWML Store in Prairie Park and check out our new LWML shirts, socks, resources, teen products, and much more!

yet have it in the language of their hearts. LBT strives to accomplish this by recruiting missionaries who they train, equip and help support.

At present, 87 missionaries are working on more than 80 projects in 19 countries on 5 different continents. LBT's goal is to have a total of 105 missionaries and 25 additional language projects on the field by 2011.

ROCK Solid News†

ROCK Solid News is published during the convention by the LWML Communication Department. Bring news items to Room 6 by 3:00 p.m. each day.

Vice President of CommunicationSandy Hardies
Public Relations Director.....Bev England
Newspaper EditorRae Ann Spitzberger
Quarterly Editor-in-Chief Nancy Graf Peters
Quarterly StaffBeth Foreman, Shari Miller,
Peggy Wunschel
Media & Marketing.....Doris Engstrom, Wendy Greiner

YWRs – Past & Present

Meet your YWRs

You have an exciting opportunity to meet your district YWRs (Young Woman Representatives) by visiting them at the YWR/Leader Development Committee booth. The time each YWR is serving at the booth will be posted on the message board and has also been shared with all district presidents. You will also have the opportunity to take your district YWR's picture at this time as they serve in the booth. Be sure to thank these YWRs for being a part of LWML and for serving your district in this capacity.

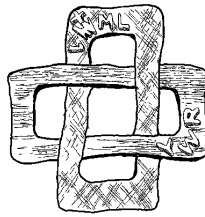

YWR Servant Activity

The YWR servant activity at convention is helping the LWML Human Care Committee with the Gifts from the Heart. Each YWR serves during her scheduled time on Wednesday and Thursday gathering, sorting and packing items brought by convention attendees. This is a great opportunity for the YWRs to bond and work together by serving and helping others in need.

Calling All Past YWRs!

Were you a Young Woman Representative at a national LWML convention? Come and share your YWR story at a **YWR Rockin' Reunion**, to be held during the lunch hour on Friday. Pick up your pre-ordered boxed lunch or purchase your lunch from the concessions, and join us for a **YWR Rockin' Reunion**. Bring your experiences and bond with other YWRs. Fun and fellowship provided. The location of this event is to be announced.

Who IS That in the Purple Hat?

Visit the Structure Committee exhibit, meet Suzy Structure, and you'll know the answer to that question. *Suzy Says:* "Come and play 'Tic-Tac-Know,' a parliamentary procedure and bylaws knowledge game. Register for our daily drawing — a chance to win a great parliamentary resource. Have your Rock Hound Passport stamped. Your passport needs to be stamped at all of the LWML committee exhibits so you can be entered in the drawing for some great LWML prizes and be a certified LWML Rock Hound."



Rockin' With The TEAM Leader ... Jesus!

Plan to visit the YWR/Leader Development Committee booth in Prairie Park! Help build a mound of rocks with leader tip ideas, look at leader materials available in the *LWML Catalog*, fill out a leader quiz

and sign up to win a banner of "Jesus — The TEAM Leader" or a copy of the new *Here I Am Lord PowerPoint®* resource. Come meet and connect with the Leader Development Committee and share ideas.

Past presidents to sign LWML history

The PR Booth will feature Pat Bilow, LWML Director of Planned Giving, and our past LWML presidents at the times listed below.

Pat will be happy to answer questions on the Gifts of Love program, and our past presidents are available to autograph Marlys Taege Moberg's book, *Women in League With the Lord*, which you may purchase at the booth. If you would like a photo with them, bring your camera! Do stop by and say hello; they will love seeing you!

Thursday

11:00 a.m. – 12:30 p.m.

Betty Duda
Gloria Edwards
Ida Mall
Virginia Von Seggern

2:00 p.m. – 3:30 p.m.

Alberta Barnes
Betty Duda
Gloria Edwards
Helen Gienapp
Ida Mall

3:30 p.m. – 5:30 p.m.

Betty Duda
Helen Gienapp
Ida Mall
Virginia Von Seggern

Friday

1:00 p.m. – 2:00 p.m.

Alberta Barnes
Betty Duda
Gloria Edwards
Helen Gienapp
Ida Mall
Virginia Von Seggern

Saturday

8:00 a.m. – 8:45 a.m.

Betty Duda
Gloria Edwards
Helen Gienapp
Ida Mall
Virginia Von Seggern